

Thank you for using our products.
INSTALLATION INSTRUCTIONS
EXCEDER 2-WIRE FIELD SELECTABLE HORN,
STROBE, AND HORN/STROBE APPLIANCES
(WALL MOUNT)

Use this product according to this instruction manual. Please keep this instruction manual for future reference.

GENERAL:

The Cooper Notification Series Exceder HN horn, ST strobe, and HS horn/strobe appliances are designed for easy installation. All models are for 12V or 24V operation. The appliance comes in two main parts. The universal mounting back plate allows the wall appliance to be mounted to a single-gang, double-gang, or four square backbox. Appliance wiring is then connected to the mounting back plate. This allows a continuity check of the entire NAC circuit before any appliances are attached. It also allows the appliances to be installed after all finish work has been completed. The installer can snap or install the appliances when all other work is complete.

⚠ WARNING: PLEASE READ THESE INSTRUCTIONS CAREFULLY BEFORE USING THIS PRODUCT. FAILURE TO COMPLY WITH ANY OF THE FOLLOWING INSTRUCTIONS, CAUTIONS AND WARNINGS COULD RESULT IN IMPROPER APPLICATION, CANDELA SETTING, INSTALLATION AND/OR OPERATION OF THESE PRODUCTS IN AN EMERGENCY SITUATION, WHICH COULD RESULT IN PROPERTY DAMAGE AND SERIOUS INJURY OR DEATH TO YOU AND/OR OTHERS.

SPECIFICATIONS:

Table 1: Models and Settings						
Model	Regulated Voltage	Voltage Range Limit per UL/ULC	Strobe (cd)	Horn	Current Draw See Table	Mounting
ST	12 (VDC)	8.0-17.5	15/15-75	~	3	Wall
	24 (VDC/VRMS)	16.0-33.0	15/15-75/30/75/95/110/135/185			
HS	12 (VDC)	8.0-17.5	15/15-75	X	4	Wall
	24 (VDC/VRMS)	16.0-33.0	15/15-75/30/75/95/110/135/185			
HN	12 (VDC/VRMS)	8.0-17.5	~	X	5	Wall
	24 (VDC/VRMS)	16.0-33.0				

STROBE AND HORN STROBE APPLIANCES:

Cooper Notification's Exceder Multi-Candela Strobes can provide a non-synchronized strobe appliance when connected directly to a Fire Alarm Control Panel (FACP), or provide a synchronized strobe appliance when used in conjunction with an FACP that incorporates the Cooper Notification sync protocol, a Cooper Notification Sync Module, or the Cooper Notification Power Supply. The Strobe Appliances are UL Listed under Standard 1971 (Signaling Devices for the Hearing Impaired) for indoor Fire Protection Service. They are listed for **indoor use only**. Cooper Notification's Exceder Horn Appliances provide a selectable Continuous or Code 3 Horn tone when connected directly to the Fire Alarm Control Panel (FACP). They can also provide a synchronized Code 3 Horn tone when used in conjunction with an FACP that incorporates the Cooper Notification sync protocol, a Cooper Notification Sync Module, or the Cooper Notification Power Supply. The Horn Appliances can be field set for High (HI), Medium (MED), or Low (LO) dBA sound output. The Horn Appliances are UL Listed under Standard 464 for Audible Signal Appliances. They are listed for **indoor use only**. All models are designed for use with either filtered DC (VDC) or unfiltered Full-Wave-Rectified (VRMS) input voltage. All inputs are polarized for compatibility with standard reverse polarity supervision of circuit wiring by a FACP. The ST Strobe, HS Horn/Strobe, and the HN Horn are for 12V or 24V operation. Strobe devices for 12V are only approved by UL to be set at 15cd, and 15-75cd, and only to be powered by DC not FWR.

NOTE: The Code 3 temporal pattern (1/2 second on, 1/2 second off, 1/2 second on, 1/2 second off, 1/2 second on, 1-1/2 off and repeat) is specified by ANSI and NFPA 72 for standard emergency evacuation signaling. **The Code 3 Horn should be used only for fire evacuation signaling and not for any other purpose.**

Table 2A: HN and HS dBA Sound Output													
Description	Volume	Reverberant Dba Per UL 464						Anechoic Per CAN/ULC-S525-07					
		HN and HS at 12V			HN and HS at 24V			HN and HS at 12V			HN and HS at 24V		
		8.0V	12.0V	17.5V	16.0V	24.0V	33.0V	8.0V	12.0V	17.5V	16.0V	24.0V	33.0V
Continuous Horn	High	83	88	91	91	93	96	89	93	96	95	99	101
	Medium	79	82	86	86	89	92	85	89	92	91	95	97
	Low	72	76	79	78	82	85	79	84	87	86	90	92
Code 3 Horn	High	80	84	86	86	89	91	87	93	96	95	99	101
	Medium	74	78	82	81	85	84	85	89	92	91	95	97
	Low	68	72	76	74	78	80	79	84	87	86	90	92

Table 2B: ULC Directional Characteristics		
Axis	dBA	Angle
Horizontal	-3dBA	80 degrees left and right
	-6dBA	85 degrees left and right
Vertical	-3dBA	80 degrees up and down
	-6dBA	90 degrees up and down

CURRENT DRAW:

Table 3: ST Strobe Current Draw (Amps)											
Strobe Candela Settings (cd)											
16.0-33.0 Volts									8.0-17.5 Volts		
Current	15	15/75	30	75	95	110	135	185	Current	15	15/75
DC	0.057	0.070	0.085	0.135	0.163	0.182	0.205	0.253	DC	0.110	0.140
FWR	0.083	0.105	0.105	0.185	0.223	0.256	0.328	0.372	FWR	~	~

Table 4: HS Horn/Strobe Current Draw (Amps)											
Strobe Candela Settings (cd)											
Current	Horn Settings	16.0-33.0 Volts								8.0-17.5 Volts	
		15	15/75	30	75	95	110	135	185	15	15/75
DC	High*	0.082	0.095	0.102	0.148	0.176	0.197	0.242	0.282	0.125	0.159
	Medium*	0.073	0.083	0.087	0.139	0.163	0.186	0.230	0.272	0.122	0.153
	Low*	0.065	0.075	0.084	0.136	0.157	0.184	0.226	0.267	0.120	0.148
FWR	High*	0.131	0.138	0.138	0.216	0.258	0.289	0.357	0.384	~	~
	Medium*	0.112	0.126	0.126	0.201	0.247	0.272	0.340	0.378	~	~
	Low*	0.106	0.120	0.120	0.196	0.235	0.265	0.331	0.375	~	~

* Current Draw is the same for the Continuous Horn and Code 3 Horn Settings.

Table 5: HN Horn Current Draw (Amps)			
Current	Horn Settings	8.0-17.5 Volts	16.0-33.0 Volts
DC	High*	0.047	0.064
	Medium*	0.026	0.044
	Low*	0.017	0.022
FWR	High*	0.073	0.086
	Medium*	0.048	0.074
	Low*	0.036	0.054

* Current Draw is the same for the Continuous Horn and Code 3 Horn Settings.

NOTE: Candela and Horn Setting will determine the current draw of the product.

When calculating the total currents use Tables 3-5 to determine the highest value of RMS current for an individual appliance, then multiply these values by the total number of appliances. Be sure to add the currents for any other appliances, including audible signaling appliances powered by the same source, and to include any required safety factors.

NOTE: The maximum number of strobes on a single notification appliance circuit shall not exceed 50.

NOTE: These notification appliances are UL Listed as "Regulated". They are intended to be used with Fire Alarm Control Panels (FACPs) whose notification circuits are UL Listed as "Regulated." These appliances shall not be used on UL Listed "Special Application" notification circuits unless the appliances are identified to be compatible in the installation instructions of the FACP or unless the FACP is identified to be compatible in this instruction manual.

NOTE: THESE APPLIANCES WERE TESTED TO THE REGULATED VOLTAGE LIMITS OF 16.0-33.0 VOLTS FOR 24 VOLT MODELS AND 8.0-17.5 VOLTS FOR 12 VOLT MODELS USING FILTERED DC FOR THE 12 VOLT RANGE AND EITHER FILTERED DC OR UNFILTERED DC FOR THE 24 VOLT RANGE VOLTAGE. DO NOT APPLY VOLTAGE OUTSIDE OF THIS RANGE.

NOTE: CHECK THE MINIMUM AND MAXIMUM OUTPUT OF THE POWER SUPPLY AND STANDBY BATTERY AND SUBTRACT THE VOLTAGE DROP FROM THE CIRCUIT WIRING RESISTANCE TO DETERMINE THE APPLIED VOLTAGE TO THE STROBES. THE MAXIMUM WIRE IMPEDANCE BETWEEN STROBES SHALL NOT EXCEED 35 OHMS.

NOTE: Strobes are not designed to be used on coded systems in which the applied voltage is cycled on and off.

NOTE: MAKE SURE THAT THE TOTAL RMS CURRENT REQUIRED BY ALL APPLIANCES THAT ARE CONNECTED TO THE SYSTEM'S PRIMARY AND SECONDARY POWER SOURCES, NOTIFICATION APPLIANCE CIRCUITS, SM, DSM SYNC MODULES, OR COOPER NOTIFICATION POWER SUPPLIES DOES NOT EXCEED THE POWER SOURCES' RATED CAPACITY OR THE CURRENT RATINGS OF ANY FUSES ON THE CIRCUITS TO WHICH THESE APPLIANCES ARE WIRED. OVERLOADING POWER SOURCES OR EXCEEDING FUSE RATINGS COULD RESULT IN LOSS OF POWER AND FAILURE TO ALERT OCCUPANTS DURING AN EMERGENCY, WHICH COULD RESULT IN PROPERTY DAMAGE AND SERIOUS INJURY OR DEATH TO YOU AND/OR OTHERS.

LIGHT OUTPUT:

Table 6A: Horizontal HS and ST Light Output		
Horizontal	UL Min Required of Rated Candela	Typical Percentage of Rated Candela
-90	25%	31%
-85	25%	41%
-80	30%	53%
-75	30%	62%
-70	35%	78%
-65	35%	93%
-60	40%	107%
-55	45%	104%
-50	55%	101%
-45	75%	101%
-40	75%	104%
-35	75%	101%
-30	75%	103%
-25	90%	107%
-20	90%	110%
-15	90%	111%
-10	90%	124%
-5	90%	215%
0	100%	271%*
5	90%	222%
10	90%	141%
15	90%	113%
20	90%	118%
25	90%	104%
30	75%	100%
35	75%	100%
40	75%	98%
45	75%	105%
50	55%	106%
55	45%	112%
60	40%	113%
65	35%	98%
70	35%	82%
75	30%	68%
80	30%	56%
85	25%	43%
90	25%	31%

Table 6B: Vertical HS and ST Light Output		
Vertical	UL Min Required of Rated Candela	Typical Percentage of Rated Candela
-90	12%	25%
-85	12%	52%
-80	12%	76%
-75	13%	95%
-70	15%	116%
-65	16%	132%
-60	18%	134%
-55	22%	135%
-50	27%	132%
-45	34%	129%
-40	46%	121%
-35	65%	142%
-30	90%	125%
-25	90%	135%
-20	90%	118%
-15	90%	103%
-10	90%	111%
-5	90%	132%
0	100%	271%*

* - Use 108% for 15/75 candela setting.

WIRING AND MOUNTING BASE:

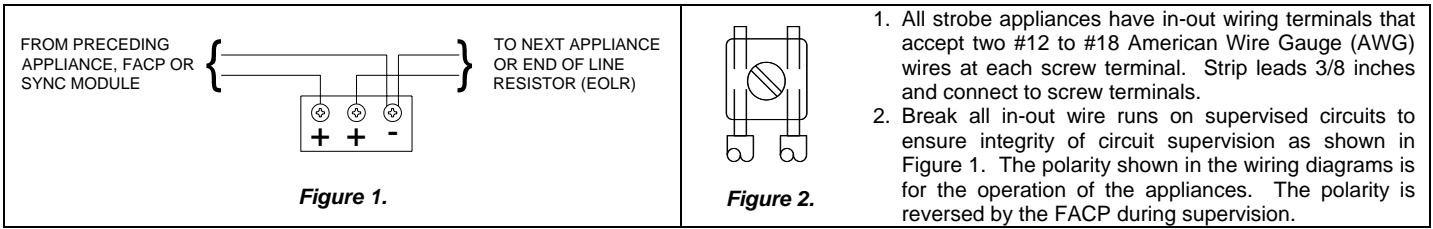

NOTE: Wiring method shall be in accordance with CSA C22.1, Canadian Electrical Code, Part 1, Safety Standard for Electrical Installations, Section 32.

WIRING AND MOUNTING SETTINGS:

NOTE: The HS and HN are factory set for the most common application of Medium dB and Code 3. The HS and ST are set to 15 candela.

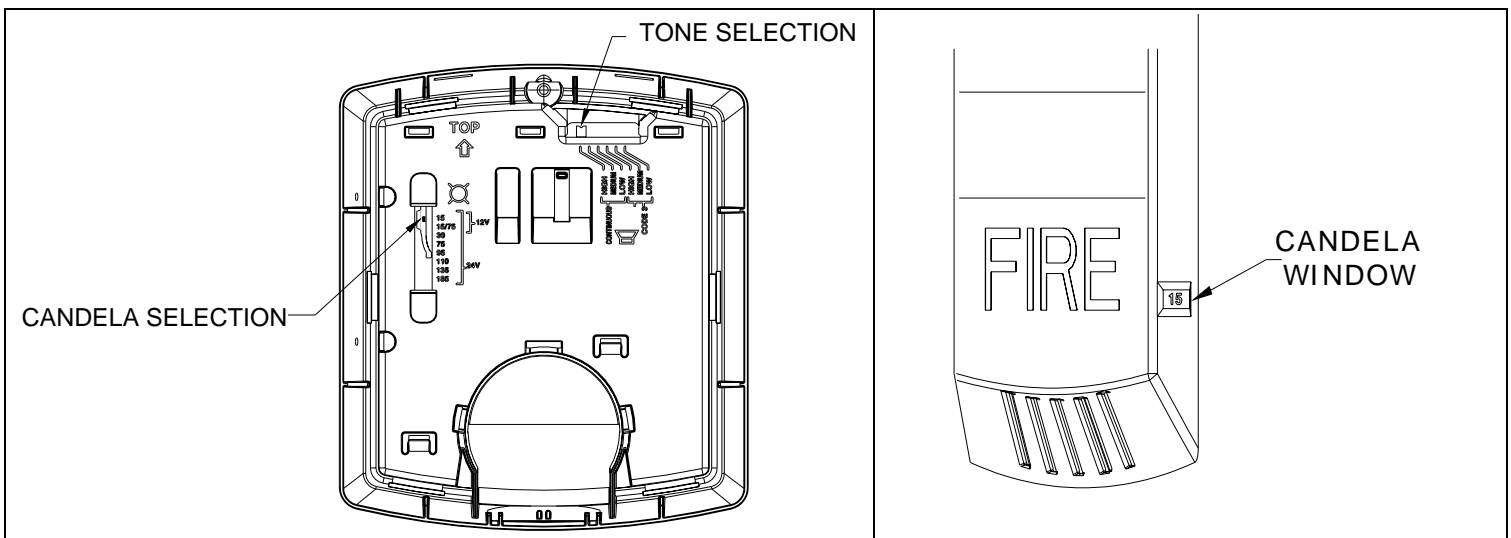

Figure 3: Candela Selector

NOTE: Candela factory settings are shown in above illustrations.

CAUTION: Check that the installed product will have sufficient clearance and wiring room prior to installing backboxes and conduit, especially if sheathed multiconductor cable or 3/4" conduit fittings are used.

Although the limits shown for each mounting option comply with the National Electrical Code (NEC), Cooper Notification recommends use of the largest backbox option shown and the use of approved stranded field wires, whenever possible, to provide additional wiring room for easy installation and minimum stress on the product from wiring.

CAUTION: DO NOT OVER TIGHTEN MOUNTING SCREWS. EXCESSIVE TORQUE CAN DISTORT THE BASE AND MAY AFFECT OPERATION.

CAUTION: WHEN USING POWER TOOLS TO SCREW DOWN THE MOUNTING PLATE TO THE ELECTRICAL BACKBOX, ENSURE THE TORQUE IS SET TO THE LOWEST SETTING AVAILABLE.

MOUNTING OPTIONS:

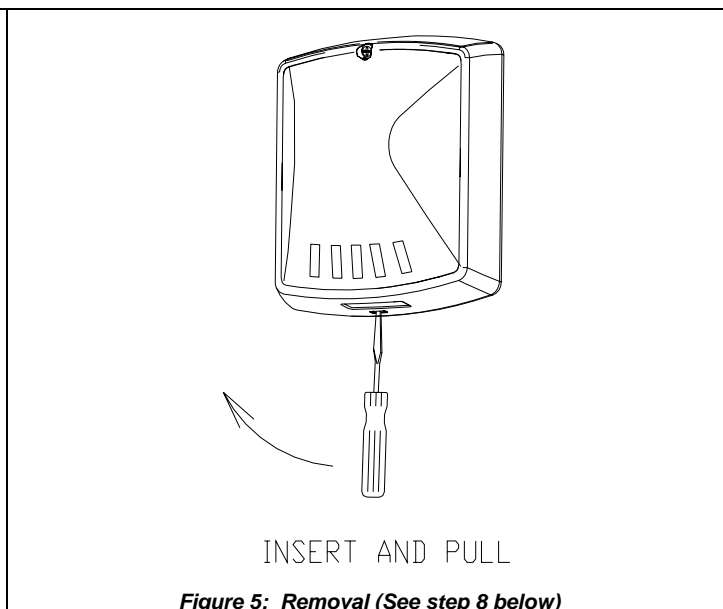
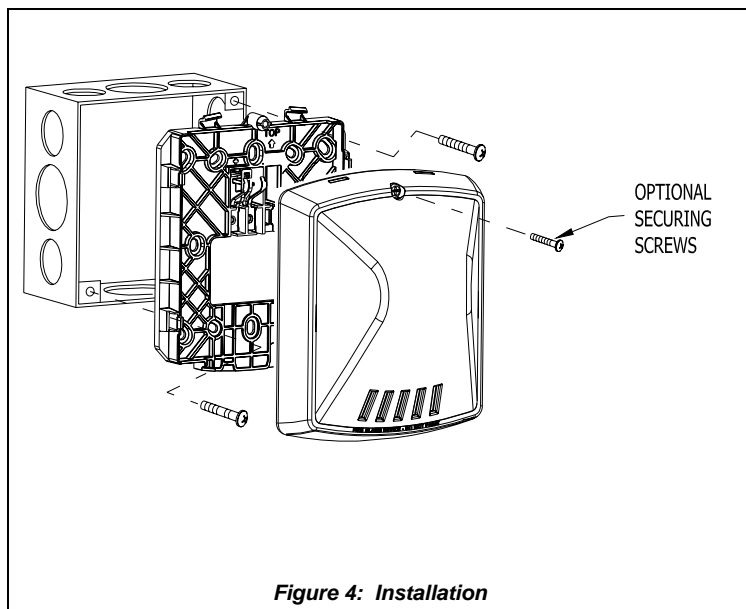

1. Install mounting plate as shown in Figure 1 to a single-gang, double-gang, 4" square backbox with the provided pan head screws.
2. Connect field wiring per Figures 1 and 2.
3. Dress wires back into backbox.
4. While performing wiring continuity check, leave terminal cover in place.
5. Remove terminal cover before snapping or installing the appliance onto the mounting plate per Figure 3.

6. Important: Device only has one mounting orientation. Match the top of the base to the top of the device. Engage both top hooks, then snap the bottom in place.
7. If it is desired to further secure the device to the base, then one optional screw is provided. To install this screw punch out the screw hole located at the top of this device.
8. To remove the appliance, insert a small flat-bladed screwdriver into the bottom opening 1/2" as shown in Figure 5. Then pry off housing with the screw driver.

⚠ WARNING: THESE APPLIANCES ARE A "FIRE ALARM DEVICE - DO NOT PAINT."

⚠ WARNING: WHEN INSTALLING STROBES IN AN OPEN OFFICE OR OTHER AREAS CONTAINING PARTITIONS OR OTHER VIEWING OBSTRUCTIONS, SPECIAL ATTENTION SHOULD BE GIVEN TO THE LOCATION OF THE STROBES SO THAT THEIR OPERATING EFFECT CAN BE SEEN BY ALL INTENDED VIEWERS, WITH THE INTENSITY, NUMBER, AND TYPE OF STROBES BEING SUFFICIENT TO MAKE SURE THAT THE INTENDED VIEWER IS ALERTED BY PROPER ILLUMINATION, REGARDLESS OF THE VIEWER'S ORIENTATION.

⚠ WARNING: A SMALL POSSIBILITY EXISTS THAT THE USE OF MULTIPLE STROBES WITHIN A PERSON'S FIELD OF VIEW, UNDER CERTAIN CIRCUMSTANCES, MIGHT INDUCE A PHOTO-SENSITIVE RESPONSE IN PERSONS WITH EPILEPSY. STROBE REFLECTIONS IN A GLASS OR MIRRORED SURFACE MIGHT ALSO INDUCE SUCH A RESPONSE. TO MINIMIZE THIS POSSIBLE HAZARD, COOPER NOTIFICATION STRONGLY RECOMMENDS THAT THE STROBES INSTALLED SHOULD NOT PRESENT A COMPOSITE FLASH RATE IN THE FIELD OF VIEW WHICH EXCEEDS FIVE (5) Hz AT THE OPERATING VOLTAGE OF THE STROBES. COOPER NOTIFICATION ALSO STRONGLY RECOMMENDS THAT THE INTENSITY AND COMPOSITE FLASH RATE OF INSTALLED STROBES COMPLY WITH LEVELS ESTABLISHED BY APPLICABLE LAWS, STANDARDS, REGULATIONS, CODES AND GUIDELINES.

NOTE: NFPA 72/ANSI 117.1 conform to ADAAG Equivalent Facilitation Guidelines in using fewer, higher intensity strobes within the same protected area.

NOTE: Final acceptance is subject to Authorities Having Jurisdiction.

⚠ CAUTION: Check the installation instructions of the manufacturers of other equipment used in the system for any guidelines or restrictions on wiring and/or locating Notification Appliance Circuits (NAC) and notification appliances. Some system communication circuits and/or audio circuits, for example, may require special precautions to assure immunity from electrical noise (e.g. audio crosstalk).

NOTE: This equipment has been tested and found to comply with the limits for a Class B digital device, pursuant to Part 15 of the FCC Rules. These limits are designed to provide reasonable protection against harmful interference in residential installation. This equipment generates, uses and can radiate radio frequency energy and, if not installed and used in accordance with the instructions, may cause harmful interference to radio communications. However, there is no guarantee that interference will not occur in a particular installation. If this equipment does cause harmful interference to radio or television reception, which can be determined by turning the equipment off and on, the user is encouraged to try to correct the interference by one or more of the following measures: 1) Reorient or relocate the receiving antenna, 2) Increase the separation between the equipment and receiver, 3) Connect the equipment into an outlet on a circuit different from that to which the receiver is connected, and 4) Consult the dealer or an experienced radio/TV technician for help.

Compatible "Cooper Notification" Devices: SM-12/24 and DSM-12/24

ANY MATERIAL EXTRAPOLATED FROM THIS DOCUMENT OR FROM COOPER NOTIFICATION MANUALS OR OTHER DOCUMENTS DESCRIBING THE PRODUCT FOR USE IN PROMOTIONAL OR ADVERTISING CLAIMS, OR FOR ANY OTHER USE, INCLUDING DESCRIPTION OF THE PRODUCT'S APPLICATION, OPERATION, INSTALLATION AND TESTING IS USED AT THE SOLE RISK OF THE USER AND COOPER NOTIFICATION WILL NOT HAVE ANY LIABILITY FOR SUCH USE.

LIMITED WARRANTY

Cooper Wheelock, Inc. dba Cooper Notification and Cooper Notification, Inc. (each, a "Seller") products must be used within their published specifications and must be PROPERLY specified, applied, installed, operated, maintained and operationally tested in accordance with these instructions at the time of installation and at least twice a year or more often and in accordance with local, state and federal codes, regulations and laws. Specification, application, installation, operation, maintenance and testing must be performed by qualified personnel for proper operation in accordance with all of the latest National Fire Protection Association (NFPA), Underwriter's Laboratories (UL), National Electrical Code (NEC), Occupational Safety and Health Administration (OSHA), local, state, county, province, district, federal and other applicable building and fire standards, guidelines, regulations laws and codes including, but not limited to, all appendices and amendments and the requirements of the local authority having jurisdiction (AHJ). Seller products when properly specified, applied, installed, operated, maintained and operationally tested as provided above are warranted against mechanical and electrical defects for a period of (a) three (3) years from date of manufacture with respect to MEDC and Seller Industrial Signals and Seller Fire and Security Notification Appliances and Devices, or (b) one (1) year from date of manufacture with respect to Waves and SafePath Voice Evacuation and Mass Notification Systems (date of manufacture is determined by date code.) Correction of defects by repair or replacement shall be at Seller's sole discretion and shall constitute fulfillment of all obligations under this warranty. THE FOREGOING LIMITED WARRANTY SHALL IMMEDIATELY TERMINATE IN THE EVENT ANY PART NOT FURNISHED BY SELLER IS INSTALLED IN THE PRODUCT. THE FOREGOING LIMITED WARRANTY SPECIFICALLY EXCLUDES ANY SOFTWARE REQUIRED FOR THE OPERATION OF OR INCLUDED IN A PRODUCT. SELLER MAKES NO REPRESENTATION OR WARRANTY OF ANY OTHER KIND, EXPRESS, IMPLIED OR STATUTORY WHETHER AS TO MECHANABILITY, FITNESS FOR A PARTICULAR PURPOSE OR ANY OTHER MATTER.

USERS ARE SOLELY RESPONSIBLE FOR DETERMINING WHETHER A PRODUCT IS SUITABLE FOR THE USER'S PURPOSES, OR WHETHER IT WILL ACHIEVE THE USER'S INTENDED RESULTS. THERE IS NO WARRANTY AGAINST DAMAGE RESULTING FROM MISAPPLIICATION, IMPROPER SPECIFICATION, ABUSE, ACCIDENT OR OTHER OPERATING CONDITIONS BEYOND SELLER'S CONTROL.

SELLER DOES NOT WARRANT THAT THE OPERATION OF THE SOFTWARE WILL BE UNINTERRUPTED OR ERROR-FREE OR THAT THE SOFTWARE WILL MEET ANY OTHER STANDARD OF PERFORMANCE, OR THAT THE FUNCTIONS OR PERFORMANCE OF THE SOFTWARE WILL MEET THE USER'S REQUIREMENTS. SELLER SHALL NOT BE LIABLE FOR ANY DELAYS, BREAKDOWNS, INTERRUPTIONS, LOSS, DESTRUCTION, ALTERATION, OR OTHER PROBLEMS IN THE USE OF A PRODUCT ARISING OUT OF OR CAUSED BY THE SOFTWARE.

THE LIABILITY OF SELLER ARISING OUT OF THE SUPPLYING OF A PRODUCT, OR ITS USE, WHETHER ON WARRANTIES, NEGLIGENCE, OR OTHERWISE, SHALL NOT IN ANY CASE EXCEED THE COST OF CORRECTING DEFECTS AS STATED IN THE LIMITED WARRANTY AND UPON EXPIRATION OF THE WARRANTY PERIOD ALL SUCH LIABILITY SHALL TERMINATE. SELLER IS NOT LIABLE FOR LABOR COSTS INCURRED IN REMOVAL, REINSTALLATION OR REPAIR OF A PRODUCT BY ANYONE OTHER THAN SELLER OR FOR DAMAGE OF ANY TYPE WHATSOEVER, INCLUDING BUT NOT LIMITED TO, LOSS OF PROFIT OR INCIDENTAL, INDIRECT, CONSEQUENTIAL, SPECIAL, PUNITIVE OR EXEMPLARY DAMAGES. THE FOREGOING SHALL CONSTITUTE THE SOLE REMEDY OF THE PURCHASER AND THE EXCLUSIVE LIABILITY OF SELLER.

IN NO CASE WILL SELLER'S LIABILITY EXCEED THE PURCHASE PRICE PAID FOR A PRODUCT.

LIMITATION OF LIABILITY

SELLER'S LIABILITY ON ANY CLAIM OF ANY KIND, INCLUDING NEGLIGENCE AND BREACH OF WARRANTY, FOR ANY LOSS OR DAMAGE RESULTING FROM, ARISING OUT OF, OR CONNECTED WITH THIS CONTRACT, OR FROM THE MANUFACTURE, SALE, DELIVERY, RESALE, REPAIR OR USE OF ANY PRODUCT COVERED BY THIS ORDER SHALL BE LIMITED TO THE PRICE APPLICABLE TO THE PRODUCT OR PART THEREOF WHICH GIVES RISE TO THE CLAIM. SELLER'S LIABILITY ON ANY CLAIM OF ANY KIND SHALL CEASE IMMEDIATELY UPON THE INSTALLATION IN THE PRODUCT OF ANY PART NOT FURNISHED BY SELLER. IN NO EVENT SHALL SELLER BE LIABLE FOR ANY CLAIM OF ANY KIND UNLESS IT IS PROVEN THAT ITS PRODUCT WAS THE DIRECT CAUSE OF SUCH CLAIM. FURTHER, IN NO EVENT, INCLUDING IN THE CASE OF A CLAIM OF NEGLIGENCE, SHALL SELLER BE LIABLE FOR INCIDENTAL, INDIRECT, CONSEQUENTIAL, SPECIAL, PUNITIVE OR EXEMPLARY DAMAGES. SOME STATES DO NOT ALLOW THE EXCLUSION OR LIMITATION OF INCIDENTAL OR CONSEQUENTIAL DAMAGES, SO THE PRECEDING LIMITATION MAY NOT APPLY TO ALL PURCHASERS.